

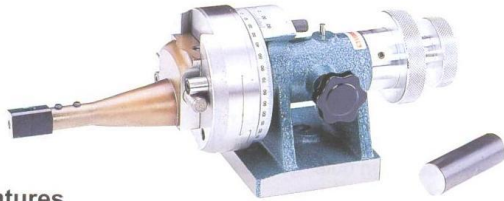

## Radius And Angle Dresser

ORDER NO.V-TDE CODE NO.2012-050

WEIGHT:9.2kgs



### Features

- No height gauge or set-up aids required.
- Radius is set on the grinder by measuring over the two pins or by inserting a gauge block for direct reading.
- Concave radius or Convex radius is determined by using either the left or right hand pins.

**B21** GRINDING MACHINE ACCESSORIES

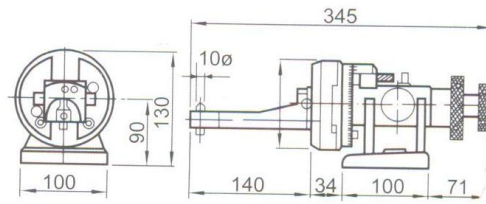

### Grinding wheel dressing application

